

# firewall

FLUELESS CAT GAS FIRED HEATERS

Model: 50" Optica & 60" Fissure



USER INSTRUCTIONS



Ouzledale Foundry Co. Limited, Long Ing, Barnoldswick, Lancashire BB18 6BN  
Tel: 01282 813235 Fax: 01282 816876 Website: <http://www.esse.com>



Ouzledale Foundry Co. Limited, Long Ing, Barnoldswick, Lancashire BB18 6BN  
Tel: 01282 813235 Fax: 01282 816876  
Email: [esse@enquiries.com](mailto:esse@enquiries.com) Website: <http://www.esse.com>



LICENSED UNDER UK PATENT GB2275331B



## 1. GENERAL

This heater has been individually designed to add charm and character to your home and provides a highly efficient heat source, coupled with the convenience of clean burning gas. Due to newness of materials the heater may give off a slight smell for a period of time after commissioning. This is quite normal and any odours should disperse after a few hours operation. An electrical appliance such as a television should not be fitted above the appliance. It is recommended that the heater is used only as a secondary heat source. It has been supplied for use on Natural Gas or LPG. The data plate is situated on the backplate (Fig1).

Fig.1. Manual version

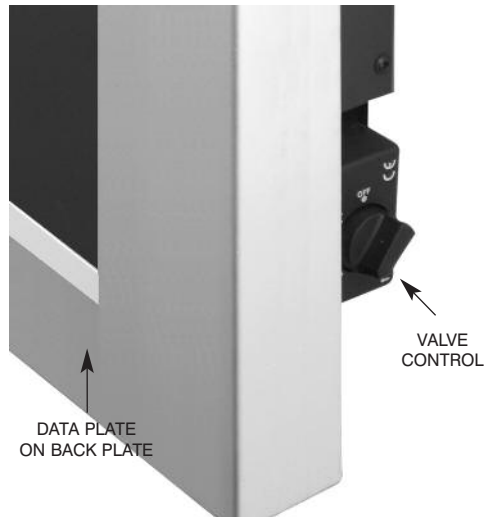

Remote version

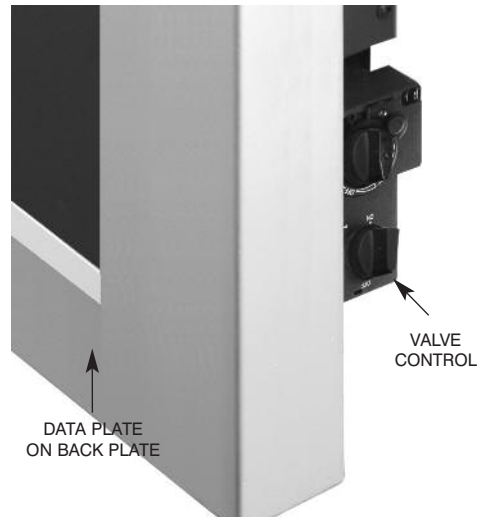

## 2. IMPORTANT NOTES

The installation must be in accordance with National Regulations and must be carried out by a qualified person. Under no circumstances should the appliance be operated without the glass inner frame attached or the glass damaged. All surfaces except the controls are considered to be working surfaces. Most parts of the heater will get hot during and after use. If young children, the elderly, or infirm are likely to be near the heater a suitable fireguard, conforming to BS8423, is recommended. Do not place any objects on top of the heater. In particular never cover or partially cover the grille. The integral catalyst should be checked by the installer upon servicing to ensure that there are no defects or obstructions. The expected life of the catalyst is in excess of 11,000 hours (10 years of normal use). After this time the catalyst should be replaced. Due to the high temperature reached within the heater, surface cracks may appear on the backboard behind the flames, this is quite normal and will not affect the safe operation of the heater. The room that the heater is installed in must not be used as a bedroom or sleeping area.

**Warning:** There are always dust particles in the air in every living space, even if it is regularly vacuumed! These particles are visible in rays of sunlight and they will not bother you as long as the concentration of particles in the air remain low. The indoor climate can only be described as bad if these particles are floating through the room in large quantities for any reason whatsoever and if the air is additionally polluted by soot and tar particles caused by the burning of oil lamps for example, and by smoking cigarettes and cigars. In a heated living space, cooled air slowly streams across the floor to the combustion appliance. The air is heated in the convection system of the heater, causing a fast rising column of warm air to develop, which then spreads throughout the room again. As a consequence, this air always contains dust and other pollutant particles that may leave deposits on cold and often damp surfaces. This is potentially a particular problem in new buildings that are not yet dry (construction moisture). An unwelcome result of this phenomenon could be discolouration of walls and /or ceilings. Wait at least 6 weeks before firing a newly bricked room or after renovations, since the construction moisture must have disappeared completely from the walls, floor and ceiling. The room where the appliance is located must be well ventilated and the required ventilation must be in compliance with the Installation Instruction. Do not use candles or oil lamps. These provide considerable quantities of pollutant and unhealthy soot particles in your home. Smoke from cigarette and cigars contain tarry substances, which may also leave deposits on colder and damp walls when heated. If the interior climate is bad, this phenomenon may also occur above radiators and lighting fixtures and at ventilation grilles, although to a lesser degree.

If decorating around the heater ensure that adequate precautions are taken to prevent paint etc from coming into contact with the heater. Do not use masking tape on the front panel.

## 3. CLEARANCES TO COMBUSTIBLES

**To electrical devices** - Under no circumstances must any electrical device (e.g Plasma T.V.) be wall mounted above a fire wall.

**To combustibles** - Minimum clearance to the sides of the heater are 100 mm (4in) but curtains, drapes and other fabrics are not permitted within a distance of 500 mm (20 in) of the stove sides. No such materials are permitted directly above the heater regardless of distance. Clearances to the front of the heater is 1000 mm (39 in). A combustible shelf may be fixed to the wall above the heater, providing that it complies with the dimensions given below and is rated at a minimum of 100°C otherwise discolouration or smells may occur. If in doubt refer to the shelf manufacturer.

The shelf depth may be increased up to a maximum of 457mm (18") but the height must also be increased accordingly. An increase in height of 25 mm is required for every 12.5 mm of additional shelf depth. For shelves that are too low, protective devices can be used such as metal heat deflectors, but it must be assured that the shelf does not reach an unacceptable temperature before relying on such a solution.

Maximum depth of shelf	Minimum distance from top of outlet grille to underside of shelf
75mm (3in)	305mm (12in)
150mm (6in)	457mm (18in)
457mm (18in)	1067mm (42in)

As with all heating appliances, any decorations, soft furnishings, and all coverings (i.e. flock, blown vinyl and embossed paper) positioned too close to the appliance may discolour or scorch.

## 4. VENTILATION

Purpose provided ventilation of 100cm<sup>2</sup> is required for this heater. This ventilation must never be blocked or partially blocked. An openable window or equivalent is also required. Ventilation fitted under, or within immediate vicinity of the heater must not be used as it may adversely effect performance of the combustion monitoring system (ODS) system.

The requirements of other appliances operating in the space or room must be taken into consideration when assessing ventilation requirements, this will have been carried out by your CORGI registered installer.

A supply of fresh air into the room is advisable to maintain temperatures within limits. The heater MUST NOT be installed in a bedroom, bathroom or any sleeping area. Additionally for L.P.G. – the heater must not be used in cellars or basements.

## 5. BURNER ARRANGEMENT

The burner should only be used with vermiculite granules as shown in the Installation Instructions. The heater must only be fitted with the vermiculite supplied. DO NOT add any extra logs or coals.

## 6. OPERATING THE HEATER

The heater is fitted with a pilot light which is also an oxygen depletion sensor (ODS), piezo spark and flame sensing device. The control is located behind the front panel on the lower right hand side (Fig 2). The pilot light is located centrally behind the burner.

Should the heater be extinguished for any reason wait 3 minutes before re-ignition is attempted. The heater should not be used at a lower setting than the 'LOW' setting position.

**Important:** It is recommended that the pilot light be left 'on' even if the main burner is turned 'off'.

Fig.2. Sideview of valve



Fig 3. Manual version - control knob

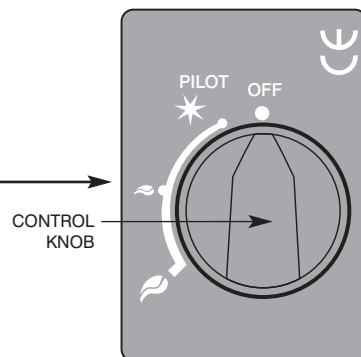

## A) MANUAL VERSION

### (a) Lighting the Pilot (Fig.3)

Depress control knob fully. Whilst depressed turn knob slowly anti-clockwise to 'PILOT' setting.

A click will be heard and the spark should light the pilot. Repeat until pilot is visibly lit. The operation of the spark can be viewed on the pilot assembly at the right hand end of the burner.

Keep knob depressed at this point for 10 - 15 seconds and release the knob. Preferably the pilot should be left to stabilise for approximately 5 minutes before igniting the burner.

### (b) High Setting (Fig.3)

Ensure that the pilot is lit as described above.

With control knob at 'PILOT' setting, depress and turn anti-clockwise to 'HIGH' setting and release the knob. After a few seconds the burner will light on high setting.

### (c) Low Setting (Fig.3)

With the heater lit on 'HIGH' setting, as described above, output can be decreased by turning the control knob progressively in a clockwise direction until the desired level is achieved, down to the 'LOW' setting.

### (d) Turning the Heater OFF (Fig.3)

From any heat setting, depress the control knob fully and turn clockwise to 'PILOT' position.

### (e) Turning the Pilot OFF (Fig.3)

From any heat setting or the 'PILOT' position, depress the control knob fully and turn clockwise to 'OFF' position.

## (B) REMOTE CONTROLLED VERSION

The heater has a pilot that must be lit manually. When lighting the pilot follow these instructions exactly.

### Lighting the Pilot

Push in gas control knob slightly and turn clockwise to 'OFF' (knob A).

**Note:** Knob A cannot be turned from 'PILOT' to 'OFF' unless knob is pushed in slightly. Do not force.

Turn knob A counter clockwise towards the ignition position (IGN) until reaching stop, press down and hold for five seconds (only pilot gas flows). Continue pressing down knob A while turning further counter clockwise to activate piezo, continue to hold down for ten seconds after pilot burner has been lit. If pilot does not light, steps 1 and 2 can be repeated immediately. Upon lighting, release knob and turn further counter clockwise to ON position. Pilot gas and main gas flow are now in accordance to the setting of Knob B (see remote transmitter operation on p6).

Fig. 6 - Remote control version - control knobs

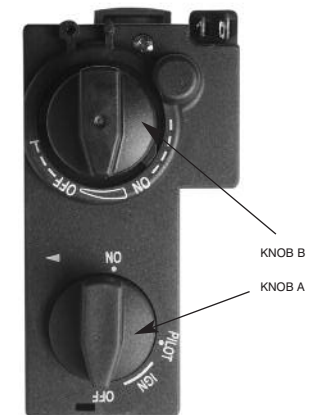

Fig. 5 - Remote Transmitter G30-ZRHSO



**Note:** Mains electrical power is not required as this system runs on batteries only (alkaline recommended). Battery information: Handset – 1 x 9V block, Receiver – 4 x 1.5V AA.

**Note:** It is recommended to turn the combination control either to the off or pilot position if the appliance is left unattended for long periods (e.g. away on holiday), so that it cannot receive commands from the remote transmitter. Exercise caution when leaving the appliance unattended, in exceptional cases sound waves from sources other than the transmitter can cause flame height adjustment. For the handset to function correctly, the transmitter must remain within range of the receiver. The transmitter should not be used in very close proximity to the receiver (less than 1m/3ft) as this could, in very rare cases, produce an electronic switching error. This error could block the motor when the knob reaches the end points of its turning radius. The knob must then be turned manually to free the blockage.

#### To turn off the gas to the heater for prolonged periods

Turn knob A clockwise until reaching stop. In this position only pilot gas flows. To shut off the valve completely, press down slightly and continue to turn clockwise from pilot position to the OFF position. The safety interlock prevents re-ignition of the pilot flame until the thermocouple has cooled down sufficiently (elapsing time will vary based on thermocouple type). Switching off the remote is not necessary.

#### FLAME HEIGHT ADJUSTMENT

- Simultaneously press both the (▲) button and the small button (A) to turn on the main burner or increase the flame height.
- For incremental increases in flame height, the small button must be continuously depressed while intermittently depressing the (▲) button.
- To decrease the flame height or shut off the main burner, simply depress only the (▼) button.

#### CHANGING BATTERIES

If the batteries in the transmitter or receiver lose power, the flame height can be adjusted by manually turning knob B until new batteries are fitted.

## 7. COMBUSTION MONITORING SYSTEM

This heater is fitted with a combustion monitoring safety device (ODS). If the heater shuts off during use for no apparent reason then several reasons may be suspected. If a door or window has been opened creating a draught, then pilot disturbance could be the problem and removal of the draught should resolve this. The heater can then be re-lit in accordance with the previous section.

If pilot disturbance is not the cause, then the ODS safety system may be in operation. Switch the heater OFF; call in your installer to check the heater and ventilation. Remedial work must be carried out as required. DO NOT allow the heater to be used until the heater and installation is passed as safe. If the pilot continues to be extinguished, you must call your installer to check the operation of the complete heater.

## 8. CLEANING

Ensure that the heater is turned off before cleaning and is cold. DO NOT use abrasive cleaning agents. This stone effect can be cleaned using a cloth with mild soap and water. Test on a small area first.

## 9. SERVICING

It is essential that the heater is regularly serviced at least annually.