



# Product Specification Tables

## Wood burning WN, WD, W35 models

### Specifications

Model	WN	WD	W35
Flue outlet	Top	Top	Top
Flue pipe diameter	6" (150mm)	6" (150mm)	6" (150mm)
Overnight burning (suitable for continuous burning)	●	●	●
Afterburn2™ technology	●	●	●
Mean boiler output inc DHW approx	○	7000Btu/h	33000Btu/h / 9.7kW/h (4.2kW to space)
Mean boiler output inc DHW - Summer setting	○	○	12000Btu/h / 3.7kW/h (1.6kW to space)
Radiant output to room (operating range)	3-5kW/h	3-5kW/h	3-5kW/h
Radiant output to room - Summer setting	○	○	2-4kW/h
Log burning firebox (not suitable for coal etc)	●	●	●
Max efficiency % (wood)	74.5	78	75.9
Additional room vents required	★	●	●

● Applicable ○ Not applicable ★ Not normally required  
**Oven Dimensions** – Top oven width 350mm, height 300mm, depth 460mm; Bottom oven width 350mm, height 200mm, depth 460mm  
**Clearances** – Non-combustible material from sides 7mm (except when adjacent to Plus2); Combustible material from side 20mm; Combustible material from back 40mm

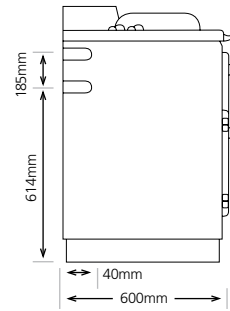

Boiler tappings for WD

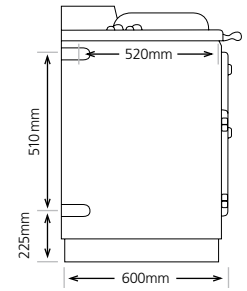

Boiler tappings for W35  
(W35 has additional back tappings which are at the same height as the side tappings and 85mm in from the side)

It is important to incorporate pipe thermostats in the plumbing of boiler models and allow for pipework heat losses when planning your system.

## Flued Gas GN, GD models

### Specifications

Model	GN	GD
Cooker options	Cooking only	Cooking & hot water
Heat Source or burner type - boiler	○	Single atmospheric heats both
Heat Source or burner type - ovens & hotplate	1xatmospheric	
Heat output to water - minimum	○	2000Btu/h / 0.6kW
Heat output to water - maximum	○	8000Btu/h / 2.4kW
Hotplate	Cast iron	Cast iron
Flue pipe diameter	4" (102mm)	4" (102mm)
Preferred vertical rise	500mm	500mm
Boiler tappings	○	C (see diagram)
Fuel consumption - Summer operation (approx)	1.3kW/h	1.3kW/h
Fuel consumption - Winter operation (approx)	2.7kW/h	2.7kW/h

○ Not applicable  
**Oven Dimensions** – Top oven width 350mm, height 300mm, depth 460mm  
Bottom oven width 350mm, height 200mm, depth 460mm

### Boiler tappings for gas and oil cookers

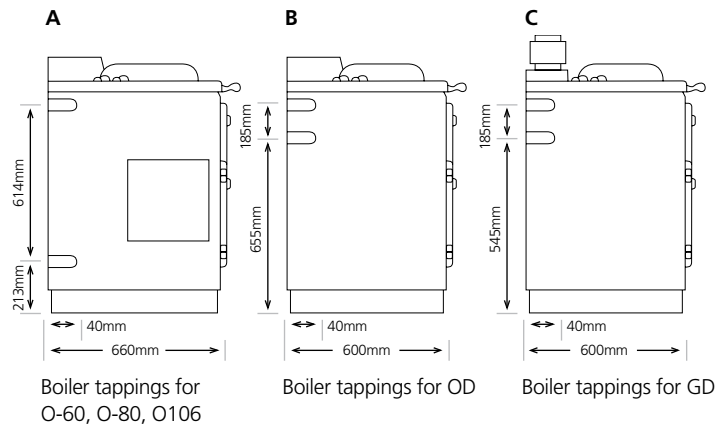

All ESSE gas cookers are available in natural gas and propane.

## Flueless Gas CAT model

Outputs: Summer Operation 1.3kW/h,  
Winter Operation 2.7kW/h.

All ESSE gas cookers are available in natural gas and propane.  
The ESSE flueless CAT cooker uses patented technology licensed in the UK GB2275331B.  
All ESSE gas appliances are CE marked.

# Solid fuel EW, EWB models

## Specifications

Model	EW €	EWB €
Flue outlet	Top	Top
Flue pipe diameter	6" (150mm)	6" (150mm)
Overnight burning (suitable for continuous burning)	●	●
Pre-heater secondary airwash	●	●
Afterburn2™ technology	●	●
Operating range (depending on fuel type and settings)	Up to 9.9kW/h	Up to 2.6kW/h to water 10.5kW/h to space
Log burning firebox grate (not suitable for coal)	Optional	Optional
Efficiency % (wood) with log burning grate	81.8	81.8
CO emissions correct to 13% O <sub>2</sub>	0.27	0.23
Additional room vents required	27cm <sup>2</sup>	45cm <sup>2</sup>

● Applicable  
**Oven Dimensions** – Oven width 320, height 340, depth 440  
**Clearances** – Non-combustible materials from side and back 20mm; Combustible material from side  
 EW 300mm EWB 200mm; Combustible material from back EW 500mm EWB 400mm; From bolster lid 416mm

# Oil O-60, O-80, O-106, OC, ON, OD models

## Specifications

Model	O-60	O-80	O-106	OC	ON	OD
Cooker options	Cooking, heating and hotwater			Cooking only	Cooking only	Cooking & hot water
Heat Source or burner type - boiler	1 x pressure jet	1 x pressure jet	1 x pressure jet	○	○	Single vaporising burner heats both
Heat Source or burner type - ovens & hotplate	1 x pressure jet	1 x pressure jet	1 x pressure jet	1 x pressure jet	1 x vaporising	
Heat output to water - minimum	○	○	○	○	○	3000Btu/h / 0.9kW
Heat output to water - maximum	60000Btu/h / 17.6kW	80000Btu/h / 23.4kW	106000Btu/h / 31.1kW	○	○	9000Btu/h / 2.6kW
Hotplate	Cast iron	Cast iron	Cast iron	Cast iron	Cast iron	Cast Iron
Flue pipe diameter	5" (126mm)	5" (126mm)	5" (126mm)	5" (126mm)	5" (126mm)	5" (126mm)
Preferred vertical rise	500mm	500mm	500mm	500mm	500mm	500mm
Boiler tappings	A (see diagram)	A (see diagram)	A (see diagram)	○	○	B (see diagram)
Fuel consumption - Summer operation (approx)	†	†	†	†	6 ltr per day	6 ltr per day
Fuel consumption - Winter operation (approx)	†	†	†	†	10 ltr per day	10 ltr per day

○ Not applicable † The oven burner will use 0.6 of a litre for the first hour from cold and thereafter 0.25 of a litre per hour to maintain a constant high oven temperature.  
**Oven Dimensions** – Top oven width 350mm, height 300mm, depth 460mm; Bottom oven width 350mm, height 200mm, depth 460mm

# Electric EC model

## Specifications

Model	EC
Cooker options	Cooking only
Heat Source - ovens & hotplate	Electric
Hotplate	Black ceramic glass

★ The ovens will use a similar amount of electricity as a conventional electric cooker. If using the electric cooker as a space heater it will use 1/3kW/h.  
**Oven dimensions** – Top oven width 350mm, height 300mm, depth 450mm  
 Bottom oven width 350mm, height 200mm, depth 450mm  
 A 45amp electric supply is required.

# Plus2 45amp, 13amp/gas models

## Specifications

Model	45amp	13amp*
Cooker options	Cooking only	Cooking only
Heat Source - ovens & hotplate	Electric	Electric and Gas
Hotplate	Black ceramic glass	Gas hob

★ The ovens use a similar amount of electricity as conventional electric cookers. If using the electric model as a space heater it will use 1/3kW per hour to keep the cooker warm. Running costs compare favourably with conventional central heating boilers.  
 \*Gas hob model comes with natural gas/LPG kit as standard.  
**Oven Dimensions** – Top oven width 350mm, height 300mm, depth 450mm  
 Bottom oven width 350mm, height 200mm, depth 450mm



MADE IN BRITAIN  
SINCE 1854



ESSE STOVES HAVE AN EXCEPTIONALLY LONG LIFE AND ARE MADE FROM RECYCLABLE MATERIAL

ESSE Engineering Limited, Ouzledale Foundry, Long Ing, Barnoldswick, Lancashire BB18 6BN  
 Tel: 01282 813235 Fax: 01282 816876 Email: enquiries@esse.com Website: http://www.esse.com

WE ARE CONSTANTLY DEVELOPING AND IMPROVING OUR PRODUCTS. WE RESERVE THE RIGHT TO ALTER SPECIFICATIONS WITHOUT PRIOR NOTICE.